

MARION TOWNSHIP FRACTION 33 R12 TWP 8 MORGAN COUNTY, OH

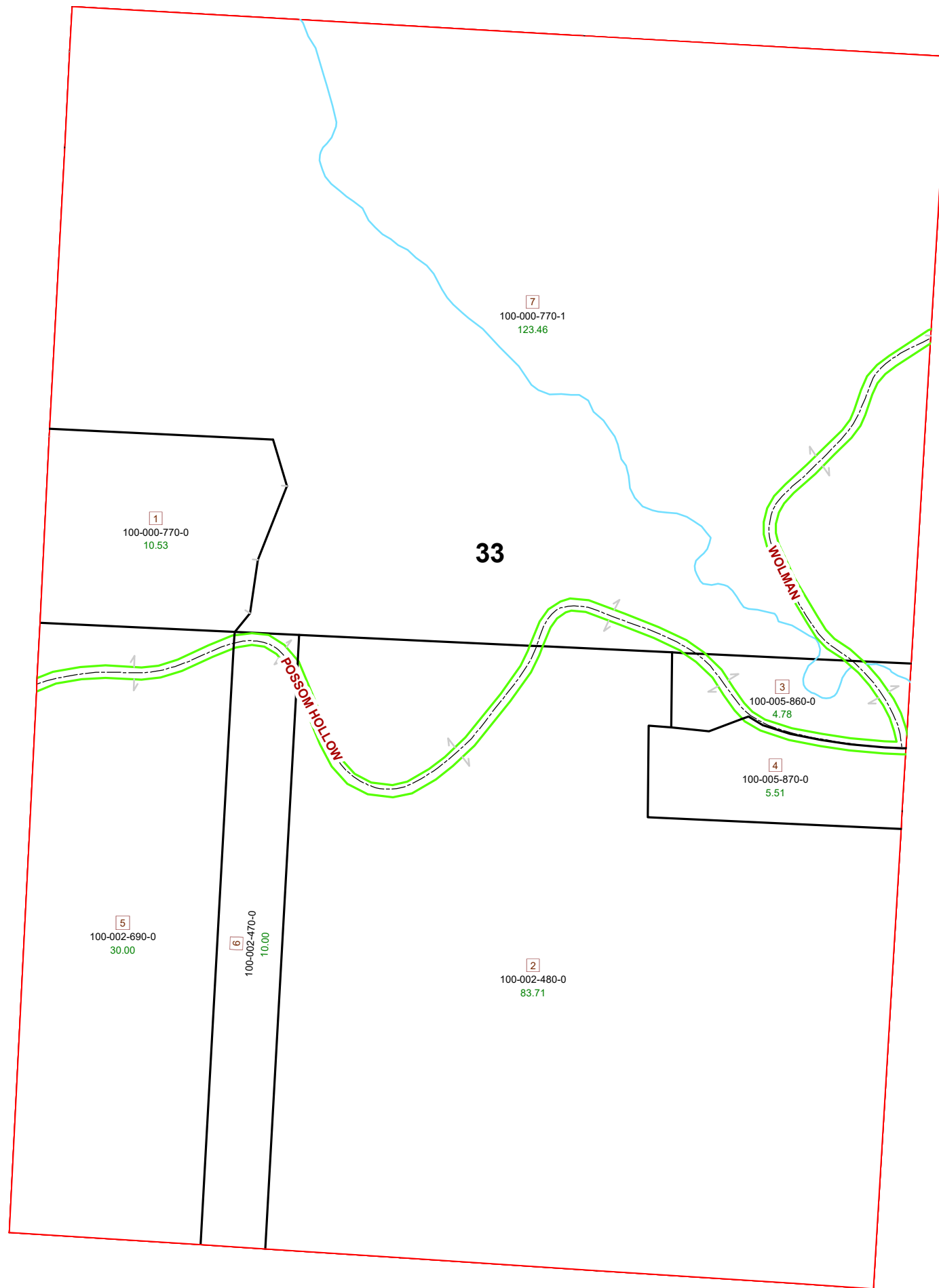

PIN	Owner	VOL	PAGE	LegalDescr	Acres
100-002-480-0	HALLAS RICHARDA & DAVID W HALLAS	D.V 178	289	R12 T08 S00 FR 33	83.71
100-002-470-0	HALLAS RICHARDA & DAVID W HALLAS	D.V 178	289	R12 T08 S00 FR 33	10
100-002-690-0	JEFFERS' TREE FARM LLC	OR172	376	R12 T08 S00 FR 33	30
100-000-770-1	KUNKEL RONALD D TOD: COPENHAVER LAUREN D	OR226	3174	R12 T08 S00 FR 33	123.462
100-000-770-0	PAGE THOMAS L & MIRANDA N MAYLE	OR234	5287	R12 T08 S00 FR 33	10.804
100-005-870-0	ROBERTSON CLIFFORD H & PATRICIA A	OR87	225	R12 T08 S00 FR 33	5.51
100-005-860-0	ROBERTSON CLIFFORD H & PATRICIA A	OR87	225	R12 T08 S00 FR 33	4.78

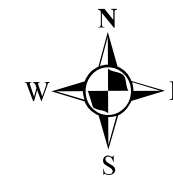

Boundaries	
----- Hidden	----- ROW
----- Hydro	----- Section
----- Roads	----- Lot
----- County	----- Township
----- Parcel	----- Parcels

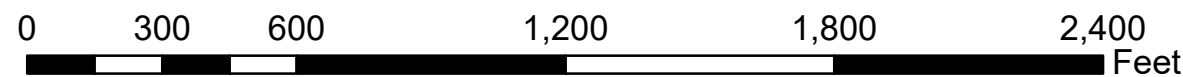

Disclaimer: The information that these maps contains is for reference purposes only. Please bring any errors to the attention of the Engineer's Office staff.

Thank you